

427 C STREET

HISTORIC MARSTON BLDG

SAN DIEGO, CA | 92101

NEW LOWER RATES
\$1.00 - \$1.25 PSF

+ ELECTRICITY

Jack Schreibman | LIC# 02172891
Jschreibman@stromcommercial.com

office: 619-243-1244
www.stromcommercial.com



427 C ST | SAN DIEGO | 92101

HISTORIC MARSTON BLDG

BUILDING HISTORY

- Originally constructed in 1896, remodeled in 1980's. The building features classic revival architecture with historic features throughout
- Original location of Marston Family Department Store; operated at this location until 1912, the building had various retailers and residents until being converted to office space in the 1980's
- The building's architect, William Templeton Johnson, also designed The Hotel Del Coronado and The La Valencia Hotel in La Jolla
- The Marston Building history can be found throughout the building with many historic photos, an open atrium, a cage-style elevator, high ceilings, and detailed finishes

John Marston

Marston moved to San Diego in 1870 when the population was just 2,300. John parlayed his early experience as a bellman at the Horton Hotel to becoming a partner and eventual owner of a general store in 1872. After years of success in business and being Secretary of San Diego's Chamber of Commerce, John decided to construct a building for a flagship store. Mr. Marston enjoyed years of success in downtown San Diego. He is known as "San Diego's First Citizen" due to founding the local YMCA, and spearheading the development of Balboa Park. His legacy is defined as an integral founder of San Diego Business and a major proponent of the beautification San Diego.



John Marston
1850 -1946



Marston House
Balboa Park Icon

427 C ST | SAN DIEGO | 92101

HISTORIC MARSTON BLDG

OFFICE AVAILABILITY SUMMARY

| SUITE | SIZE | RATE |
|-------|----------|------------|
| 202 | 2,571 SF | \$1.00 + E |
| 400 | 855 SF | \$1.25 + E |
| 406 | 2,310 SF | \$1.00 + E |
| 407 | 879 SF | \$1.25 + E |
| 410 | 1,573 SF | \$1.25 + E |
| 416 | 1,495 SF | \$1.00 + E |

Ownership prefers month-to-month leases, providing great flexibility to new tenants in the building and area.



FLOORPLAN

FOURTH FLOOR

SECOND FLOOR



202 - 2,787 SF

THIRD FLOOR



309 - 632 SF

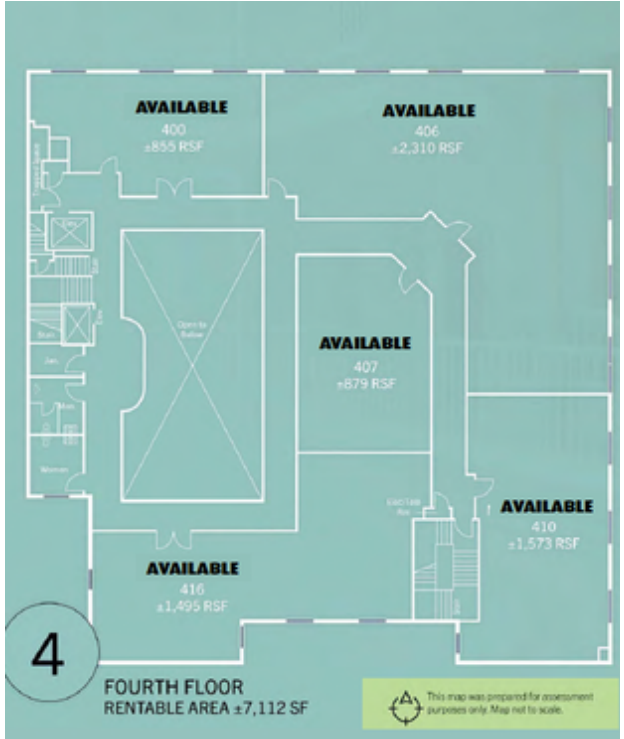

- 400 - 855 SF
- 406 - 2,310 SF
- 407 - 879 SF
- 410 - 1,573 SF
- 416 - 1,495 SF

427 C ST

SAN DIEGO | 92101

HISTORIC MARSTON BLDG

LOCATION SUMMARY

The Historic Marston Building is conveniently located only blocks away from Downtown San Diego's most notable attractions. Located in the Civic Core, the building is located on the Transit line with additional nearby parking, and in walkable distance of the House of Blues, Kimpton, CVS, Ross, a bank, and a park.

On Transit line. Parking nearby

Walkable restaurants: Mocozy ; The Local Eatery & Drinking Hole ; Crab Hut ; Starbucks ; Donut Bar ; Tender Greens

Downtown: Petco Park, Airport, Public Transportation, Courthouse,

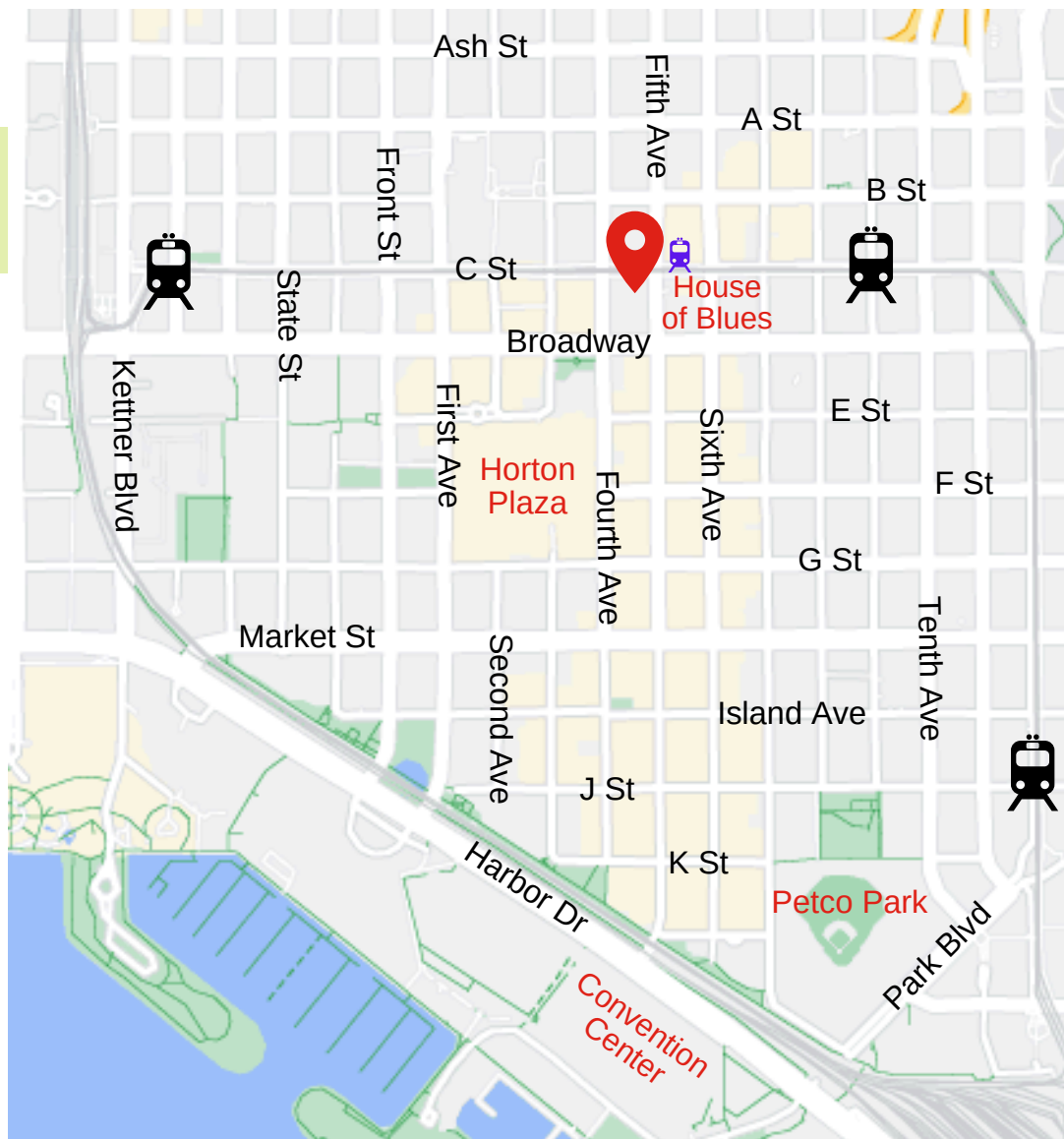

CONTACT:

office: 619-243-1244
www.stromcommercial.com

Jack Schreibman | LIC# 02172891
Jschreibman@stromcommercial.com

