

# 427 C STREET

HISTORIC MARSTON BLDG

SAN DIEGO, CA | 92101



Hans Strom | LIC# 01222709  
Hans@stromcommercial.com

Jack Schreibman | LIC# 02172891  
Jschreibman@stromcommercial.com

office: 619-243-1244  
www.stromcommercial.com





# 427 C ST | SAN DIEGO | 92101

## HISTORIC MARSTON BLDG

### BUILDING HISTORY

- Originally constructed in 1896, remodeled in 1980's. The building features classic revival architecture with historic features throughout
- Original location of Marston Family Department Store; operated at this location until 1912, the building had various retailers and residents until being converted to office space in the 1980's
- The building's architect, William Templeton Johnson, also designed The Hotel Del Coronado and The La Valencia Hotel in La Jolla
- The Marston Building history can be found throughout the building with many historic photos, an open atrium, a cage-style elevator, high ceilings, and detailed finishes

### John Marston

Marston moved to San Diego in 1870 when the population was just 2,300. John parlayed his early experience as a bellman at the Horton Hotel to becoming a partner and eventual owner of a general store in 1872. After years of success in business and being Secretary of San Diego's Chamber of Commerce, John decided to construct a building for a flagship store. Mr. Marston enjoyed years of success in downtown San Diego. He is known as "San Diego's First Citizen" due to founding the local YMCA, and spearheading the development of Balboa Park. His legacy is defined as an integral founder of San Diego Business and a major proponent of the beautification San Diego.



**John Marston**  
1850 -1946



**Marston House**  
Balboa Park Icon

# 427 C ST | SAN DIEGO | 92101

## HISTORIC MARSTON BLDG

### OFFICE AVAILABILITY SUMMARY

SUITE	SIZE	RATE
202	2,571 SF	\$1.75 + E
210	507 SF	\$1.75 + E
309	632 SF	\$1.75 + E
400	855 SF	\$1.75 + E
406	2,310 SF	\$1.75 + E
407	879 SF	\$1.75 + E
410	1,573 SF	\$1.75 + E
416	1,495 SF	\$1.75 + E
BASEMENT	10,787 SF	\$1.35 + E



# FLOORPLAN

## SECOND FLOOR

### BASEMENT

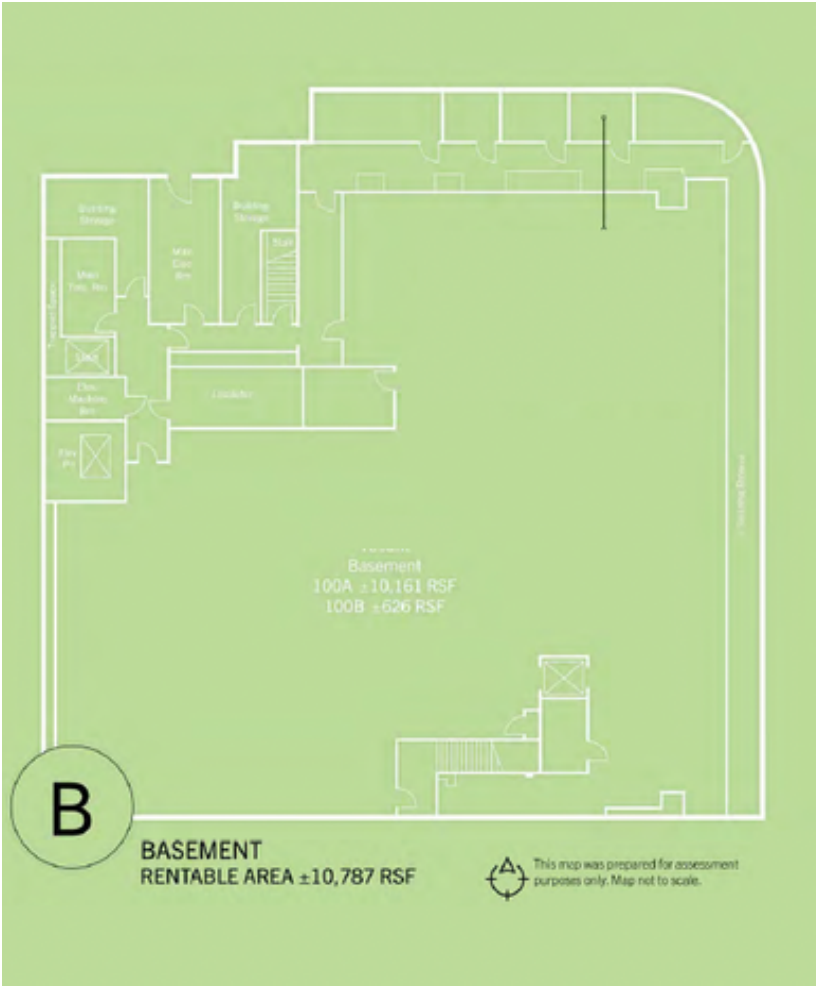

10,787 SF  
\$1.35 PSF

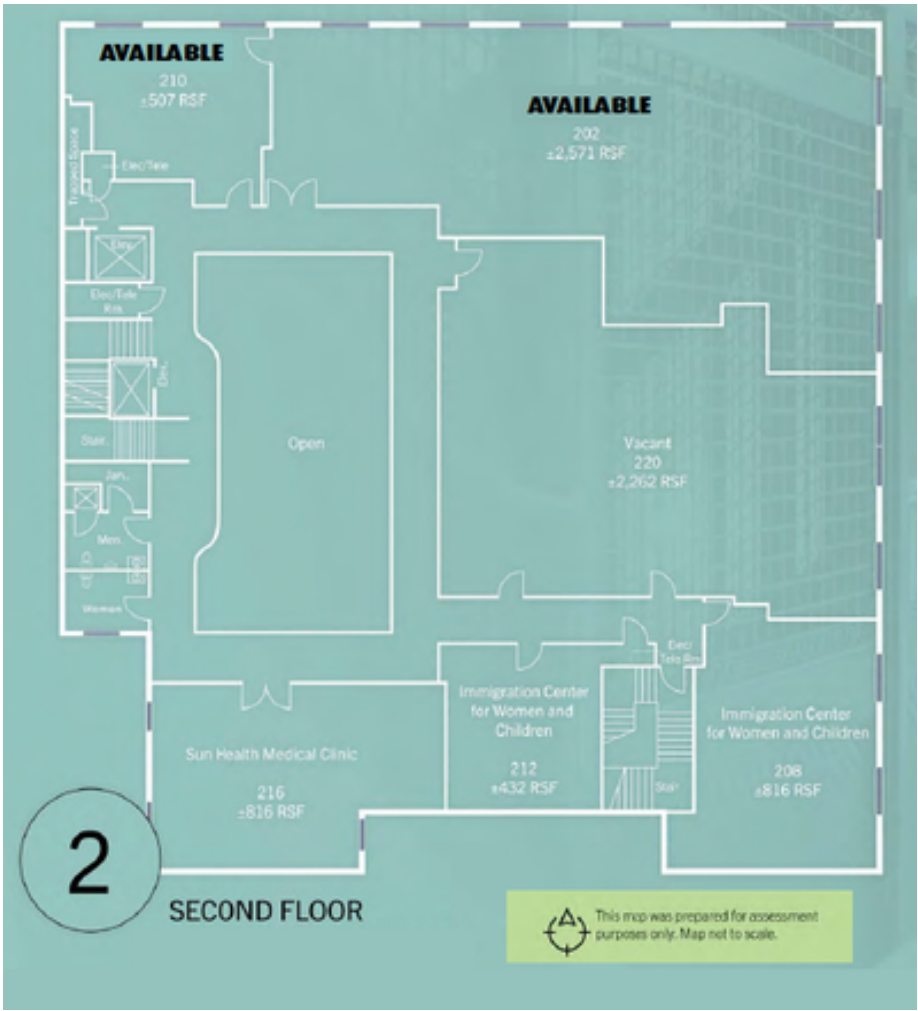

202 - 2,787 SF  
210 - 507 SF



# FLOORPLAN

## THIRD FLOOR



309 - 632 SF

## FOURTH FLOOR

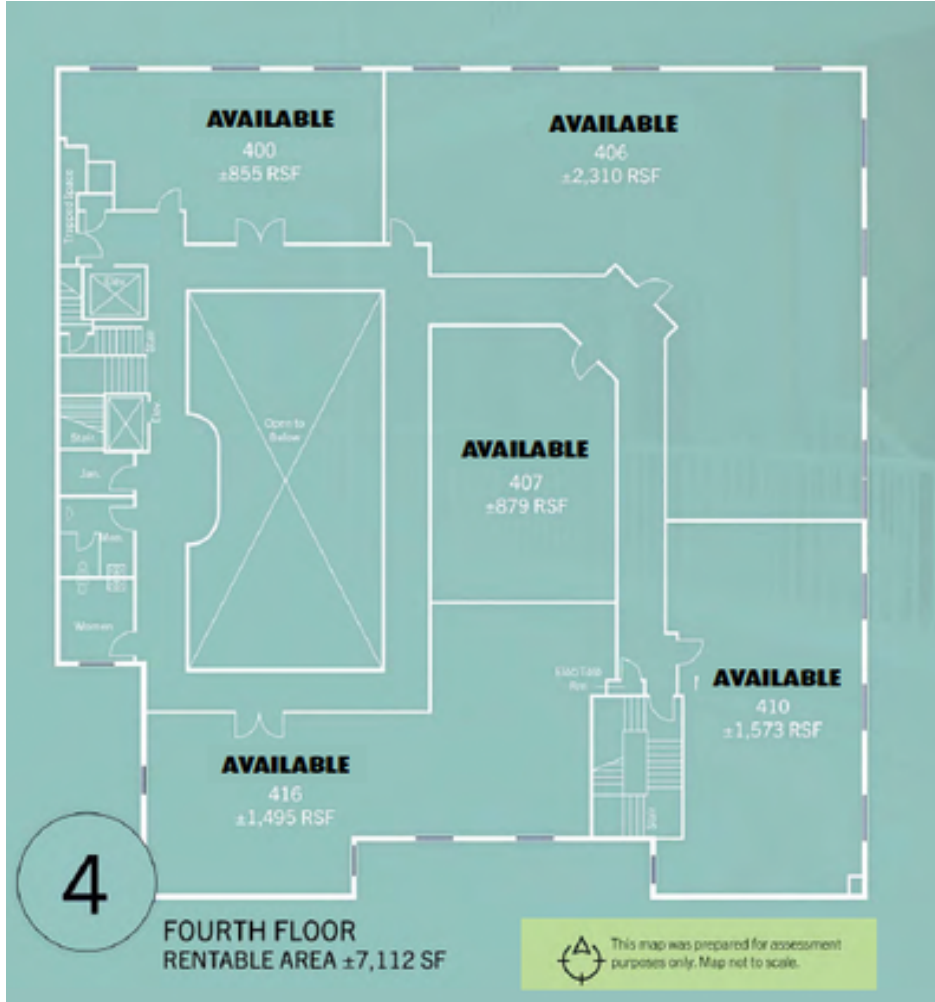

400 - 855 SF  
406 - 2,310 SF  
407 - 879 SF  
410 - 1,573 SF  
416 - 1,495 SF

# 427 C ST

SAN DIEGO | 92101

## HISTORIC MARSTON BLDG

### LOCATION SUMMARY

The Historic Marston Building is conveniently located only blocks away from Downtown San Diego's most notable attractions. Located in the Civic Core, the building is located on the Transit line with additional nearby parking, and in walkable distance of the House of Blues, Kimpton, CVS, Ross, a bank, and a park.

On Transit line. Parking nearby

Walkable restaurants: Mocozy ; The Local Eatery & Drinking Hole ; Crab Hut ; Starbucks ; Donut Bar ; Tender Greens

Downtown: Petco Park, Airport, Public Transportation, Courthouse,



### CONTACT:

office: 619-243-1244  
[www.stromcommercial.com](http://www.stromcommercial.com)

Hans Strom | LIC# 01222709  
[Hans@stromcommercial.com](mailto:Hans@stromcommercial.com)

Jack Schreibman | LIC# 02172891  
[Jschreibman@stromcommercial.com](mailto:Jschreibman@stromcommercial.com)

