



**OPEN HIGH-BAY  
OFFICE SPACE  
FOR LEASE**

2,827 SF - \$2.30 PSF  
+Electric

**2605 STATE ST.**

BANKERS HILL | 92103

STROMCOMMERCIAL.COM | (619)243-1244



# FURNISHED



# CONFERENCE ROOM



# MOVE-IN READY



HANS STROM | LIC#01222709

HANS@STROMCOMMERCIAL.COM

JACK SCHREIBMAN | LIC#02172891

JSCHREIBMAN@STROMCOMMERCIAL.COM

STROMCOMMERCIAL.COM (619)243-1244

CONTACT



# 2605 STATE ST



## LOCATION

In the Northwest corner of Bankers Hill, quick access to I-15 Freeway, Hillcrest, Balboa Park, Downtown, Little Italy, Mission Hills. Minutes from Airport and surrounded by Multi-Family.

### WALK SCORE OF 86

Coffee shop across the street. Close walk to restaurants, bars, and retail in both Banker's Hill and Little Italy. 1/2 block from Maple Canyon Trail, and First Avenue Bridge

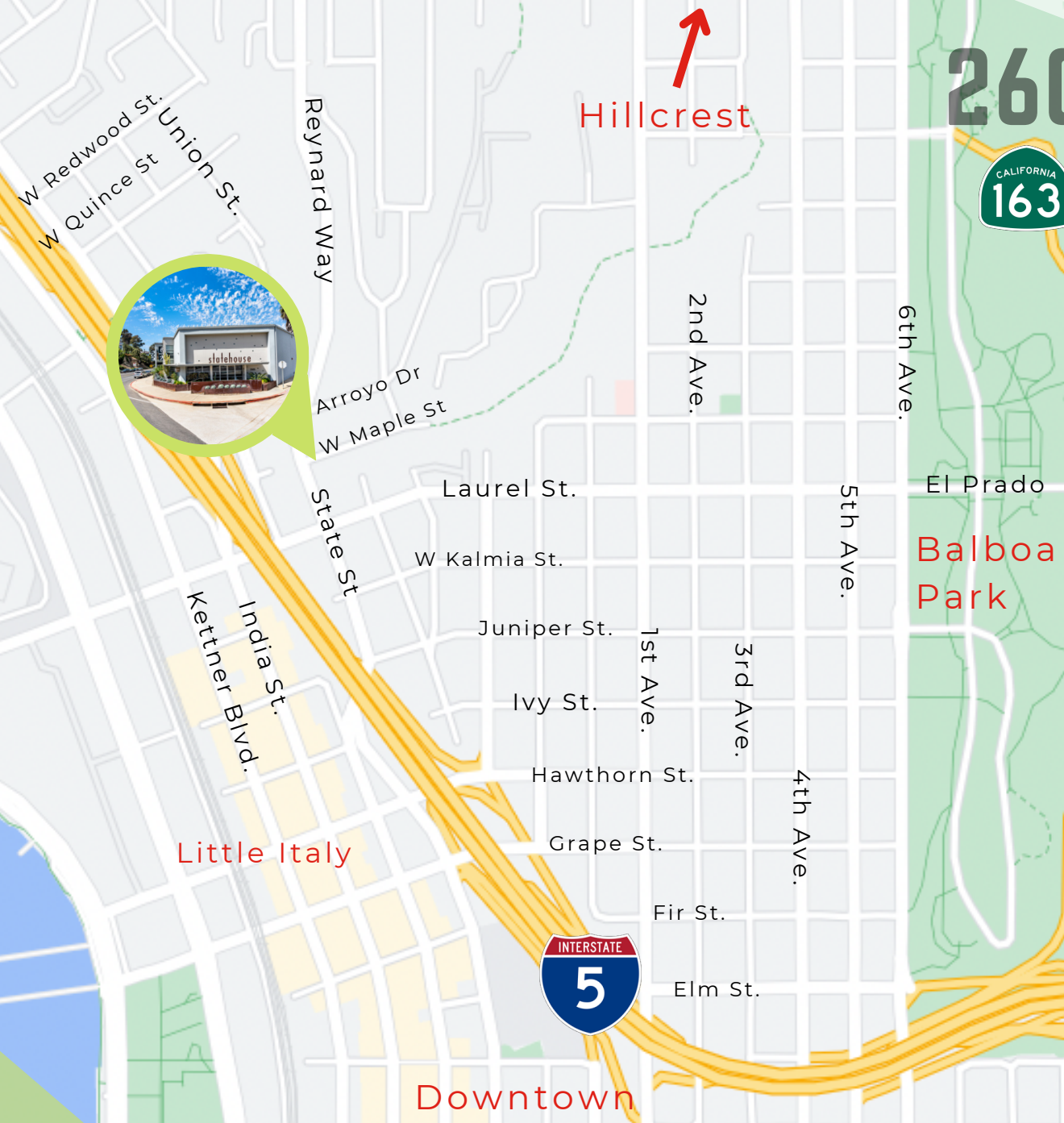

HANS STROM | LIC#01222709

HANS@STROMCOMMERCIAL.COM

JACK SCHREIBMAN | LIC#02172891

JSCHREIBMAN@STROMCOMMERCIAL.COM

STROMCOMMERCIAL.COM (619)243-1244

CONTACT

# FLOOR PLANS

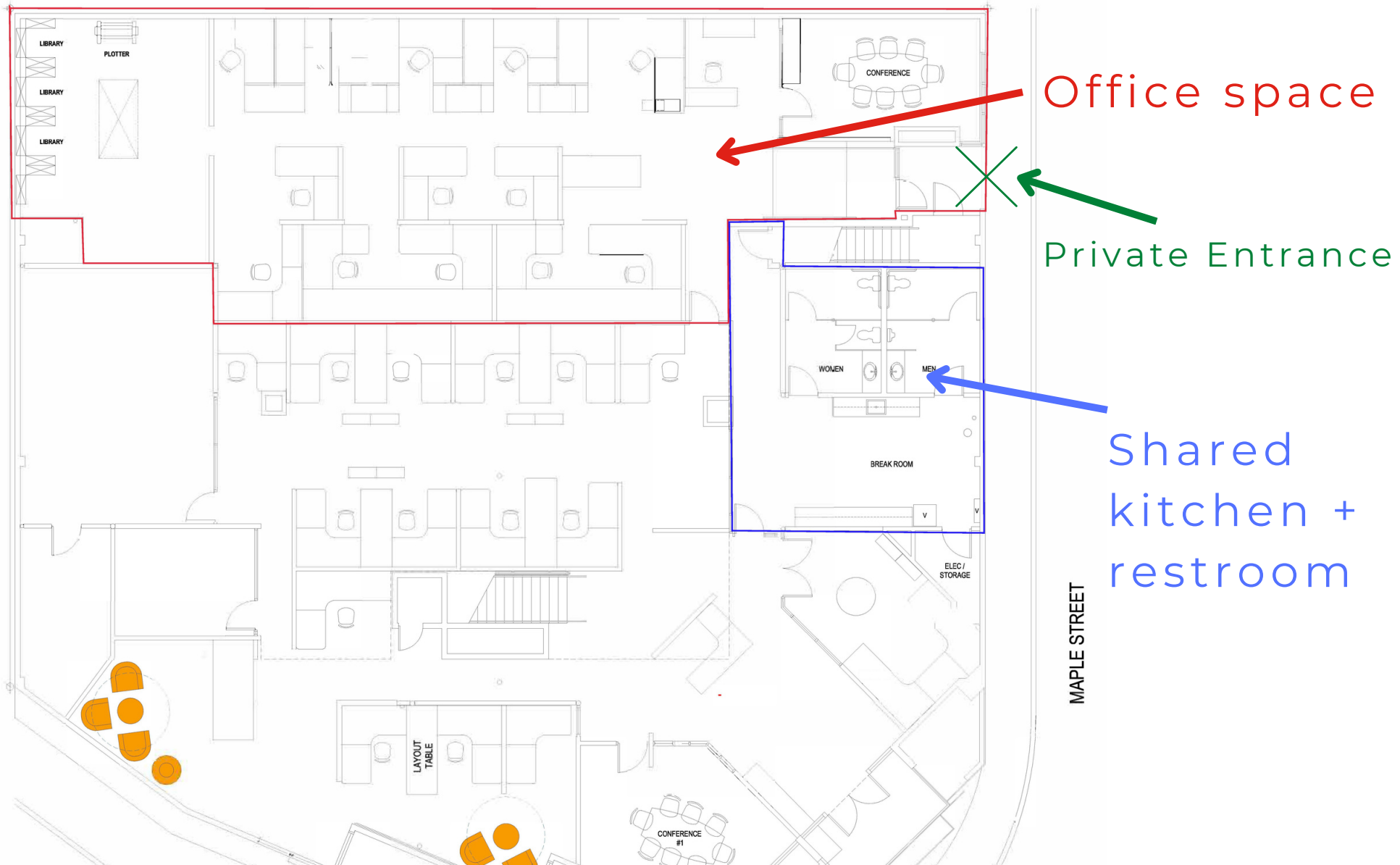

HANS STROM | LIC#01222709

HANS@STROMCOMMERCIAL.COM

JACK SCHREIBMAN | LIC#02172891

JSCHREIBMAN@STROMCOMMERCIAL.COM

STROMCOMMERCIAL.COM (619)243-1244

CONTACT