



BARRIOHAUS

955-961 S. 16th Street
| San Diego, CA 92113

CREATIVE OFFICE SPACES FOR LEASE

955 S. 16th Street: Approx. 1,522 SF | \$1.95/SF + Electric

961 S. 16th Street: Approx. 5,028 SF | \$1.95/SF + Electric

Strom Commercial

www.stromcommercial.com

(619) 243-1244



Hans Strom | hans@stromcommercial.com | Lic. #01222709

Jack Kirk | jack@stromcommercial.com | Lic. #01905664

Jordan Williams | jordan@stromcommercial.com | Lic. #01717714

BARRIOHAUS

BARRIO LOGAN
CREATIVE OFFICE SPACES FOR LEASE



955 S. 16TH STREET

APPROX. 1,522 SF | \$1.95/SF + ELEC.

- Natural brick walls and concrete flooring
- First floor open creative office space
- Exposed ducting, high ceilings
- HVAC
- Private restroom
- Reserved gated parking available 

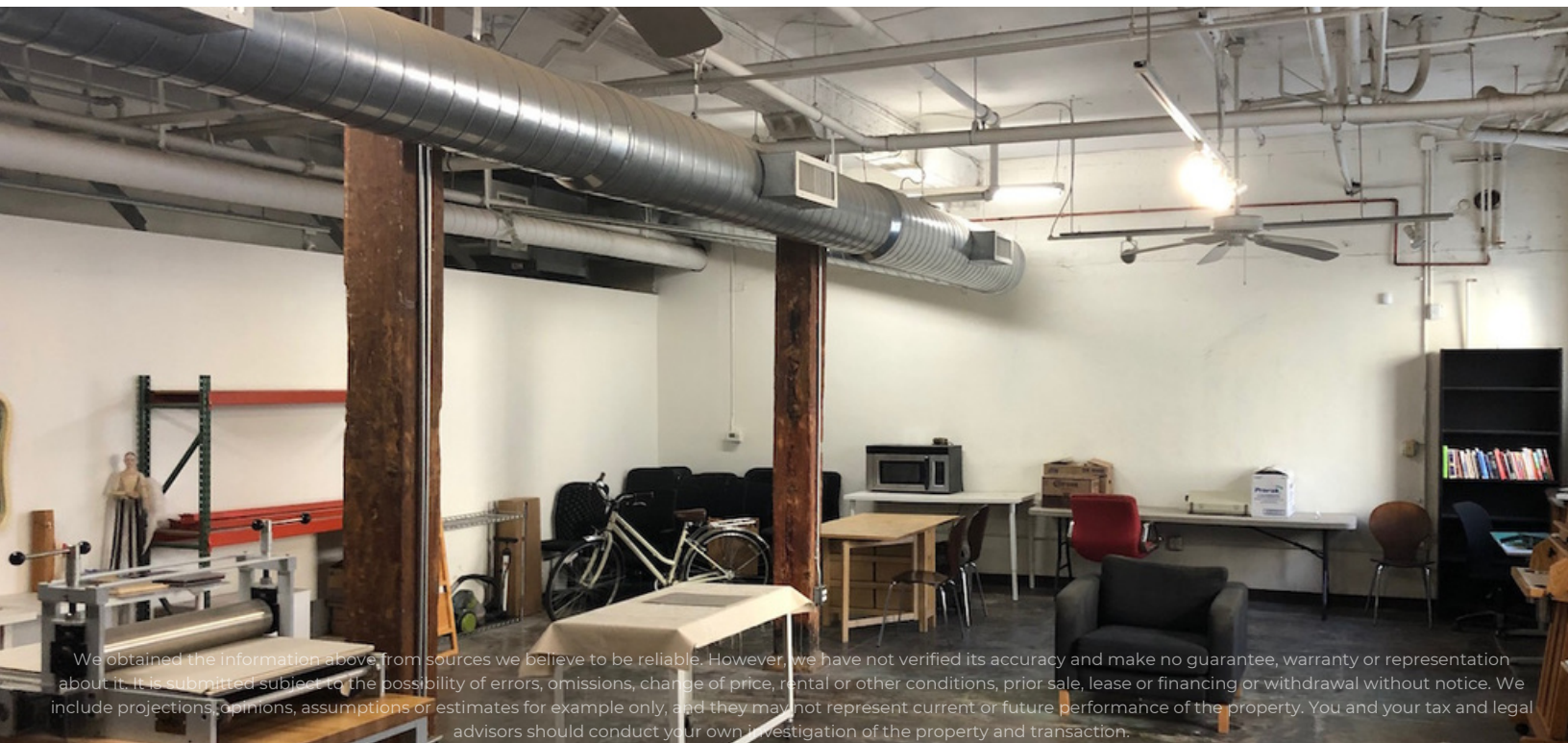

We obtained the information above from sources we believe to be reliable. However, we have not verified its accuracy and make no guarantee, warranty or representation about it. It is submitted subject to the possibility of errors, omissions, change of price, rental or other conditions, prior sale, lease or financing or withdrawal without notice. We include projections, opinions, assumptions or estimates for example only, and they may not represent current or future performance of the property. You and your tax and legal advisors should conduct your own investigation of the property and transaction.

Hans Strom | Jack Kirk | Jordan Williams | Bro. Lic. #01222709
Strom Commercial | Office: (619) 243-1244 | www.stromcommercial.com



BARRIOHAUS

BARRIO LOGAN
CREATIVE OFFICE SPACES FOR LEASE

961 S. 16TH STREET

APPROX. 5,028 SF | \$1.95/SF + ELEC.



- Second floor creative office space with private elevator & kitchenette
- Exposed wood truss ceilings, exposed ducting, new flooring
- Newly remodeled private restrooms
- Glass-lined offices
- HVAC
- Reserved gated parking available 



Hans Strom | Jack Kirk | Jordan Williams | Bro. Lic. #01222709
Strom Commercial | Office: (619) 243-1244 | www.stromcommercial.com

