

BARRIOHAUS

National Ave & S. 16th Street
San Diego, CA 92113



FORMER COFFEE SPACE FOR LEASE

1616 National Ave | ± 2,235 SF | \$2.00/SF + \$0.40 NNN

Hans Strom | LIC #01222709
hans@stromcommercial.com

Jack Schreibman | LIC #02172891
jschreibman@stromcommercial.com



STROM | COMMERCIAL
619.243.1244
www.stromcommercial.com

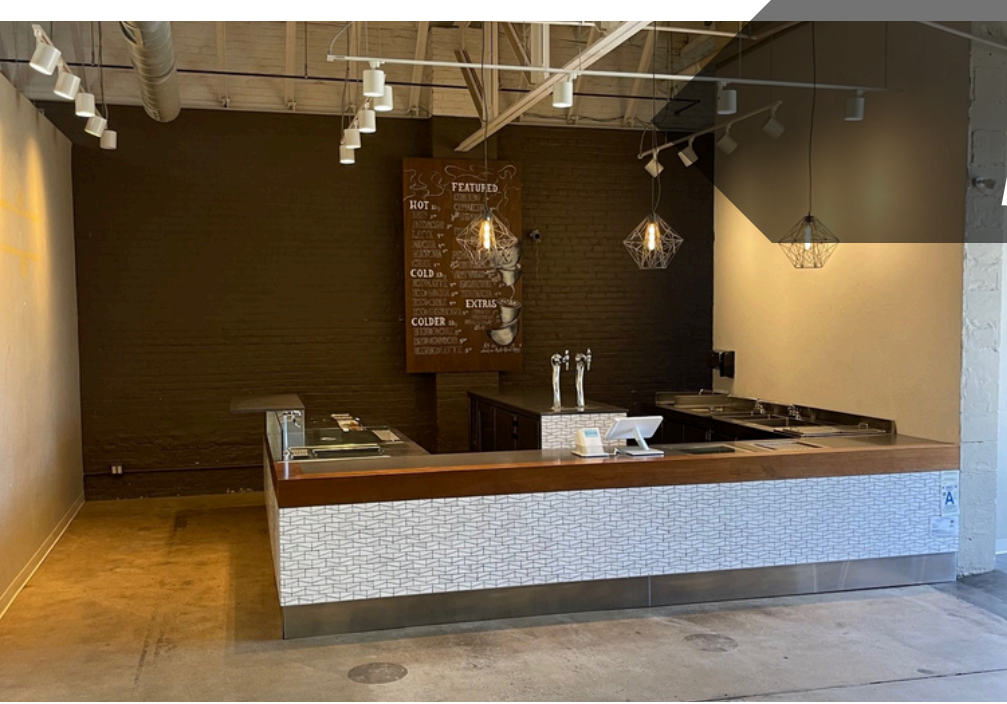

1616 NATIONAL AVE

APPROX. 2,235 SF | \$2.00/SF + \$0.40 NNN

HIGHLIGHTS:

- 3-5 year lease term
- Full coffee bar
- Exposed ducting, high ceilings
- Former coffee roasting/cafe space
- HVAC
- Two shared common restrooms
- Reserved gated parking available
- Gas & venting for coffee roaster in place

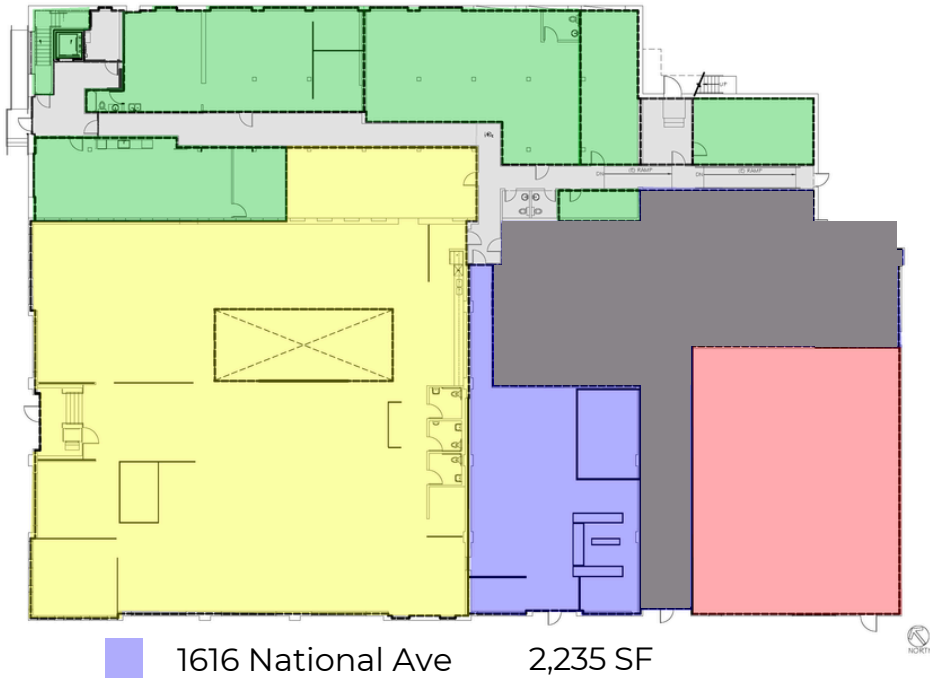

BARRIOHAUS |

BARRIO LOGAN
FORMER COFFEE SPACE FOR LEASE



Hans Strom | LIC #01222709
hans@stromcommercial.com

Jack Schreibman | LIC #02172891
jschreibman@stromcommercial.com



STROM | COMMERCIAL
619.243.1244
www.stromcommercial.com